

D
Indian Affairs
School Files

(RG 10, Volume 6218)

File 471-5, part 1

Sault Ste Marie Agency - Spanish Residential
School - Roman Catholic - Building Maintenance
- Supplies - Accounts. - (Plans). 1922 - 1926.

File 471-5, part 2

Sault Ste Marie Agency - Spanish Residential
School - Roman Catholic - Building Maintenance
- Supplies - Accounts. 1927 - 1932.

 File 471-5, part 3

Sault Ste Marie Agency - Spanish Residential
School - Roman Catholic - Building Maintenance
- Supplies - Accounts. 1932 - 1935. ?

File 471-5, part 4

Sault Ste Marie Agency - Spanish Residential
School - Roman Catholic - Building Maintenance
- Supplies - Accounts. 1936 - 1941.

File 471-5, part 5

Sault Ste Marie Agency - Spanish Residential
School - Roman Catholic - Building Maintenance
- Supplies - Accounts. 1941 - 1949.

RG 10, Volume 6218, File 471-5, Part 3

P.S. Economy is an essential consideration if we are to undertake the building at all

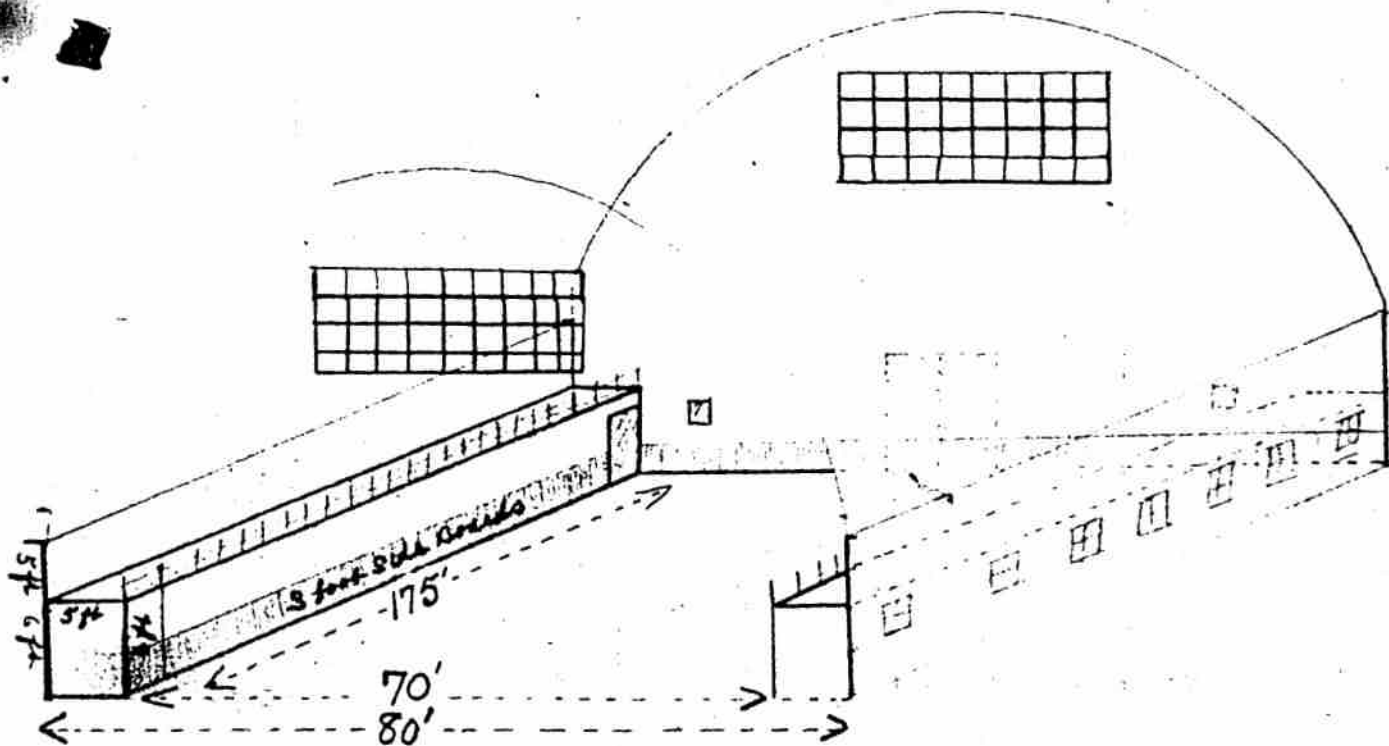

36-0-13

Memorandum

Indian Residential School,
Spanish, Ont.,
7 May, 1942.



The Secretary,
Indian Affairs Branch,
Department of Mines & Resources,
Dear Sir:

Pupils of this school have need of dental attention. Approximately 57 extractions and 32 fillings are required in the boys' section, and in the girls', 61 extractions and 154 fillings.

A clinic of at least four days will be necessary.

Doctor Boyd says that three of the girls will have to be put to sleep before extractions can be made.

Yours truly,

J. Howitt
J. Howitt

Indian Affairs. (RG 10, Volume 6219, file 471-13, part 3)

Indian Affairs
School Files

(RG 10, Volume 6218)

File 471-5, part 1

Sault Ste Marie Agency - Spanish Residential
School - Roman Catholic - Building Maintenance
- Supplies - Accounts. - (Plans). 1922 - 1926.

File 471-5, part 2

Sault Ste Marie Agency - Spanish Residential
School - Roman Catholic - Building Maintenance
- Supplies - Accounts. 1927 - 1932.

File 471-5, part 3

Sault Ste Marie Agency - Spanish Residential
School - Roman Catholic - Building Maintenance
- Supplies - Accounts. 1932 - 1935.

File 471-5, part 4

Sault Ste Marie Agency - Spanish Residential
School - Roman Catholic - Building Maintenance
- Supplies - Accounts. 1936 - 1941.

File 471-5, part 5

Sault Ste Marie Agency - Spanish Residential
School - Roman Catholic - Building Maintenance
- Supplies - Accounts. 1941 - 1949.

PRIVY COUNCIL
CANADA.

ORIGINAL ON

File 1-1-5

File

CERTIFIED TO BE A TRUE COPY OF A MINUTE OF A MEETING OF THE
TREASURY BOARD, APPROVED BY HIS EXCELLENCY THE ADMINISTRATOR
IN COUNCIL, ON THE 20th JUNE 1940.

MINES AND RESOURCES.



The Board had under consideration a memorandum
from the Honourable the Minister of Mines and Resources
reporting:-

"That the estimates for the fiscal year 1940-41, Vote No.
181, Indian Affairs Branch, Mines and Resources, provide
\$32,200 in the amounts detailed hereunder, for the purchase
and maintenance of equipment, repairs and improvements for
the following Church-owned Indian Residential Schools:

(a) <u>QUEBEC</u>		
Fort George Church of England Residential School	\$	400.
Fort George Roman Catholic Residential School		1,400.
(b) <u>ONTARIO</u>		
Albany Roman Catholic Residential School		1,500.
Fort William Roman Catholic Residential School		500.
Moose Fort Church of England Residential School		500.
Spanish Roman Catholic Residential School		1,000.
(c) <u>SASKATCHEWAN</u>		
Thunderchild Roman Catholic Residential School		1,300.
(d) <u>ALBERTA</u>		
Ermineskin Roman Catholic Residential School		1,750.
Grouard Roman Catholic Residential School		2,400.
Holy Angels Roman Catholic Residential School		500.
Joussard Roman Catholic Residential School		2,400.
St Albert Roman Catholic Residential School		500.
Sturgeon Lake Roman Catholic Residential School		2,400.
Vermilion Roman Catholic Residential School		1,100.
Wabasca Church of England Residential School		500.
Wabasca Roman Catholic Residential School		1,500.
Whitefish Lake Church of England Residential School		500.
(e) <u>BRITISH COLUMBIA</u>		
Cariboo Roman Catholic Residential School		1,300.
Christie Roman Catholic Residential School		1,000.
Kitamaat United Church Residential School		500.
Port Simpson United Church Residential School		500.
Squamish Roman Catholic Residential School		500.
St Mary's Mission Roman Catholic Residential School		2,850.
(f) <u>NORTHWEST TERRITORIES</u>		
Aklavik Church of England Residential School		850.
Aklavik Roman Catholic Residential School		500.
Fort Resolution Roman Catholic Residential School		1,500.
Providence Mission Roman Catholic Residential School		2,050.
		<u>\$32,200</u>

Honourable
The Minister of Mines and Resources

Indian Affairs
School Files

(RG 10, Volume 6218)

File 471-5, part 1

Sault Ste Marie Agency - Spanish Residential
School - Roman Catholic - Building Maintenance
- Supplies - Accounts. - (Plans). 1922 - 1926.

File 471-5, part 2

Sault Ste Marie Agency - Spanish Residential
School - Roman Catholic - Building Maintenance
- Supplies - Accounts. 1927 - 1932..

File 471-5, part 3

Sault Ste Marie Agency - Spanish Residential
School - Roman Catholic - Building Maintenance
- Supplies - Accounts. 1932 - 1935.

File 471-5, part 4

Sault Ste Marie Agency - Spanish Residential
School - Roman Catholic - Building Maintenance
- Supplies - Accounts. 1936 - 1941.

File 471-5, part 5

Sault Ste Marie Agency - Spanish Residential
School - Roman Catholic - Building Maintenance
- Supplies - Accounts. 1941 - 1949.

AND TRAINING SERVICE
[Handwritten signature]



INDIAN AFFAIRS BRANCH

Ottawa, November 11, 1942.

Memorandum:

MR. JACKSON

EX D
A

I am sending forward herewith File No. 36-0-24, Spanish Residential School Audit.

The Spanish School has at this date an enrolment of 250 pupils, for which we allow per capita grant of \$160, paid on the basis of 92.24%. This school, the only residential school operated by the Jesuit Order in Canada, consists of two main buildings, both of stone construction - one for girls and the other for boys. In addition to the main buildings, there are the ordinary outdoor buildings - barns, stables, machine sheds, etc.

*Noted 26/11/42
Hawking*

This school has been operated at a loss over a period of years, despite frequent changes in the principalship. The present Principal, Father Primeau, who was recently appointed, visited the Department twice during the summer months. He intimated at that time that the boys' building, particularly the interior, was in a somewhat deplorable condition and was urgently in need of repairs. It was his intention, also, at that time to undertake a certain amount of reconstruction with the object of enlarging the dormitories. The small dormitories that existed at that time were, in his judgment, very insanitary. In view of the large enrolment and the fact that this is the only Catholic residential school in the eastern section of Ontario and the school to which we send a great many orphans from the province of Quebec, it was decided to allow Father Primeau \$1,000 for repairs. The amount referred to by you in our telephone conversation will form part of this allowance. This is, as you have stated, a church-owned school. The expenditures on repairs at this school, however, have been very low over a long period of years. You will note, in the audit statement, that the church authorities have been spending substantial sums on the repair of these buildings from year to year.

I would certainly appreciate it if a definite decision were reached in respect to the policy of the Government on the repair, operation and general upkeep of these church-owned residential schools. I am convinced, after my recent visit to Mount Elgin - a report of which will reach you in due course - that these residential schools should either be kept in a good state of repair or closed. I do not suppose, however, that the purchase of paint would mean much one way or the other. If we are to work in close co-operation with these principals, there has got to be a certain amount of "Give and Take" on both sides.

I should like to direct your attention particularly to the salaries paid to the staff at this institution. Were it not for the willingness of the members of this staff to accept a nominal salary, the institution could not operate under the present financial arrangement.

It is my understanding that a delegation representing the churches will interview the Minister toward the

p.t.o.

end of December. It has occurred to me that the operation, repair and upkeep of our residential schools, particularly the church-owned schools, might be carefully reviewed at that time.



R. N. Hoey
R. N. Hoey
Supt. of Welfare and Training.

Mr. Hoey:

I discussed this matter with the Minister. He inquired what had been the practice in the past regarding the assistance granted to the churches in respect to government-owned and church-owned institutions and if the policy was different in regard to the two classes of schools. He expressed the view that it would be interesting to have a statement prepared showing - say over a period of the last five years - what money had been spent in repairs, either directly by the Government or by way of grant to both classes, showing separately the schools operated by the Roman Catholic church and those operated by the other denominations. Would there be much trouble in preparing this statement?

In so far as the particular request is concerned for the repairs to the Spanish Indian Residential School, the last audit statement showing the joint operations of both the boys and girls schools would indicate that they are not being operated at a loss. Under the circumstances, therefore, and in view of the present need for economy, it is thought that the church should be asked to look after this expense.

November 25, 1942.

G. V. Jackson
G. V. Jackson,
Chief Executive Assistant.

TOTAL COST OF REPAIRS AT
SPANISH INDIAN RESIDENTIAL SCHOOL
for Fiscal Years 1935-36 to 1941-42 inclusive

1935-36	-	\$878.17
1936-37	-	529.67
1937-38	-	628.14
1938-39	-	1,750.75
1939-40	-	1,365.58
1940-41	-	943.98
1941-42	-	805.93
Total	-	<u>6,902.22</u>

Indian Affairs. (RC 10, Volume 6218, file 471-5, part 5)

PUBLIC ARCHIVES
ARCHIVES PUBLIQUES
CANADA